

# BALI 4.4

Voyager (2025)

Allure Navis D.O.O. • Antuna Branka Šimića 33 • 21000 Split • Croatia

Phone: +385 95 502 0094

Phone 2: +385 99 844 2210

E-mail: info@allure-navis.com

Web: www.allure-navis.com

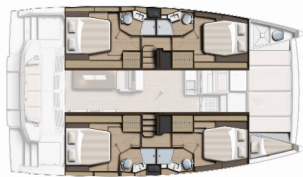

|                        |  |
|------------------------|--|
| <b>Yacht Base</b>      | Trogir, Yachtclub Seget (Marina Baotic), Croazia |
| <b>Yacht ID</b>        | 7209   |
| <b>Yacht Brands</b>    | Catana   |
| <b>Yacht Name</b>      | Voyager  |
| <b>Production Year</b> | 2025   |
| <b>Length</b>          | 44 Ft  |
| <b>Cabins</b>          | 4 + 1  |
| <b>Berths</b>          | 8 + 2 + 1  |
| <b>Max Persons</b>     | 11   |
| <b>WC/Shower</b>       | 4 + 1  |

**ATTREZZATURE DI COPERTA:** Barbecue, Doccetta esterna, Fly sunbathing area, Forward cockpit, Piattaforma da bagno, Tavolo pozzetto, Teak pozzetto, Tendalino, Tender

**COMFORT:** Biancheria da letto, Cuscini per pozzetto, Cuscini prendisole per la tuga

**CUCINA:** Acqua calda, Congelatore, Creatore di caffè, Fornello, Forno, Forno a microonde, Frigorifero, Utensili da cucina

**ELETTRAUTO YACHT:** Aria condizionata, Carica batterie, Generatore, Inverter, Pannelli solari, Riscaldamento

**INTERIOR:** Convertible table in salon, Electric fans in cabins, Tavolo, WC elettrici

**L'INTRATTENIMENTO:** Casse in pozzetto, Radio lettore CD, TV

**NAVIGAZIONE:** Autopilota, Carte nautiche e nautica guida, GPS plotter cartografico - Pozzetto, Portolano, Tridata

**SICUREZZA:** Radio VHF

**VELE:** Electric halyard winch

# PRICE AND AVAILABILITY

Bali 4.4 Voyager (2025)



|  |   |   |  |
|--|---|---|--|
| <b>13.06. - 20.06.2026</b><br>Not available              | <b>20.06. - 27.06.2026</b><br>Not available               | <b>27.06. - 04.07.2026</b><br>Not available               | <b>04.07. - 11.07.2026</b><br>Not available              |
| <b>11.07. - 18.07.2026</b><br>Not available              | <b>18.07. - 25.07.2026</b><br>9.616 € <del>12.020 €</del> | <b>25.07. - 01.08.2026</b><br>Not available               | <b>01.08. - 08.08.2026</b><br>Not available              |
| <b>08.08. - 15.08.2026</b><br>Not available              | <b>15.08. - 22.08.2026</b><br>Not available               | <b>22.08. - 29.08.2026</b><br>8.544 € <del>10.680 €</del> | <b>29.08. - 05.09.2026</b><br>Not available              |
| <b>05.09. - 12.09.2026</b><br>Not available              | <b>12.09. - 19.09.2026</b><br>Not available               | <b>19.09. - 26.09.2026</b><br>Not available               | <b>26.09. - 03.10.2026</b><br>Not available              |
| <b>05.10. - 10.10.2026</b><br>Not available              | <b>10.10. - 17.10.2026</b><br>3.104 € <del>3.880 €</del>  | <b>17.10. - 24.10.2026</b><br>3.104 € <del>3.880 €</del>  | <b>24.10. - 31.10.2026</b><br>3.136 € <del>3.920 €</del> |
| <b>31.10. - 07.11.2026</b><br>3.136 € <del>3.920 €</del> | <b>07.11. - 14.11.2026</b><br>3.136 € <del>3.920 €</del>  | <b>14.11. - 21.11.2026</b><br>3.136 € <del>3.920 €</del>  | <b>21.11. - 28.11.2026</b><br>3.136 € <del>3.920 €</del> |
| <b>28.11. - 05.12.2026</b><br>3.136 € <del>3.920 €</del> | <b>05.12. - 12.12.2026</b><br>3.136 € <del>3.920 €</del>  | <b>12.12. - 19.12.2026</b><br>3.136 € <del>3.920 €</del>  | <b>19.12. - 26.12.2026</b><br>3.136 € <del>3.920 €</del> |
| <b>02.01. - 09.01.2027</b><br>3.536 € <del>4.420 €</del> | <b>09.01. - 16.01.2027</b><br>3.536 € <del>4.420 €</del>  | <b>16.01. - 23.01.2027</b><br>3.536 € <del>4.420 €</del>  | <b>23.01. - 30.01.2027</b><br>3.536 € <del>4.420 €</del> |
| <b>30.01. - 06.02.2027</b><br>3.536 € <del>4.420 €</del> |   |   |  |