

# BAVARIA CRUISER 56

Anassa (2014)



Allure Navis D.O.O. • Antuna Branka Šimića 33 • 21000 Split • Croatia

Phone: +385 95 502 0094

Phone 2: +385 99 844 2210

E-mail: [info@allure-navis.com](mailto:info@allure-navis.com)

Web: [www.allure-navis.com](http://www.allure-navis.com)

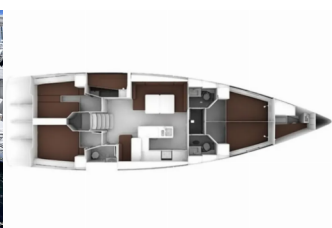

**ATTREZZATURE DI COPERTA:** Paraspruzzi, Teak pozzetto, Tentalino, Tender con motore fuoribordo

**ELETTRAUTO YACHT:** Aria condizionata, Batteria, Generatore

**INTERIOR:** WC elettrici

**L'INTRATTENIMENTO:** Radio lettore CD

**NAVIGAZIONE:** Elica di prua, GPS plotter cartografico - Pozzetto

|                        |                               |
|------------------------|-------------------------------|
| <b>Yacht Base</b>      | Athens, Alimos Marina, Grecia |
| <b>Yacht ID</b>        | 6929                          |
| <b>Yacht Brands</b>    | Bavaria                       |
| <b>Yacht Name</b>      | Anassa                        |
| <b>Production Year</b> | 2014                          |
| <b>Length</b>          | 55 Ft                         |
| <b>Cabins</b>          | 5 + 1                         |
| <b>Berths</b>          | 10 + 2                        |
| <b>WC/Shower</b>       | 4                             |

# PRICE AND AVAILABILITY

Bavaria Cruiser 56 Anassa (2014)



|  |  |  |  |
|--|--|--|--|
| <b>13.06. - 20.06.2026</b><br>Not available              | <b>20.06. - 27.06.2026</b><br>Not available              | <b>27.06. - 04.07.2026</b><br>Not available              | <b>04.07. - 11.07.2026</b><br>Not available              |
| <b>11.07. - 25.07.2026</b><br>Not available              | <b>25.07. - 01.08.2026</b><br>Not available              | <b>01.08. - 15.08.2026</b><br>Not available              | <b>15.08. - 22.08.2026</b><br>Not available              |
| <b>22.08. - 29.08.2026</b><br>Not available              | <b>29.08. - 05.09.2026</b><br>Not available              | <b>05.09. - 12.09.2026</b><br>Not available              | <b>12.09. - 19.09.2026</b><br>Not available              |
| <b>19.09. - 26.09.2026</b><br>Not available              | <b>26.09. - 03.10.2026</b><br>Not available              | <b>03.10. - 17.10.2026</b><br>Not available              | <b>17.10. - 24.10.2026</b><br>2.290 € <del>4.300 €</del> |
| <b>24.10. - 31.10.2026</b><br>Not available              | <b>31.10. - 07.11.2026</b><br>2.290 € <del>4.300 €</del> | <b>07.11. - 14.11.2026</b><br>2.290 € <del>4.300 €</del> | <b>14.11. - 21.11.2026</b><br>2.290 € <del>4.300 €</del> |
| <b>21.11. - 28.11.2026</b><br>2.290 € <del>4.300 €</del> | <b>28.11. - 03.04.2027</b><br>Not available              |  |  |