

# HANSE 588

Oceanelle (2024)



Allure Navis D.O.O. • Antuna Branka Šimića 33 • 21000 Split • Croatia

Phone: +385 95 502 0094

Phone 2: +385 99 844 2210

E-mail: info@allure-navis.com

Web: www.allure-navis.com

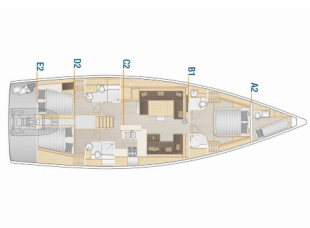

<b>Yacht Base</b>	Trogir, Yachtclub Seget (Marina Baotić), Croazia
<b>Yacht ID</b>	5480
<b>Yacht Brands</b>	Hanse Yachts
<b>Yacht Name</b>	Oceanelle
<b>Production Year</b>	2024
<b>Length</b>	56 Ft
<b>Cabins</b>	3 + 1
<b>Berths</b>	6 + 2 + 1
<b>Max Persons</b>	9
<b>WC/Shower</b>	3 + 1

**ATTREZZATURE DI COPERTA:** Barbecue, Di sollevamento idraulico Plancetta, Doccetta esterna, Frigorifero a pozzetto, Hard Biminitop, Paraspruzzi, Passerella idraulica, Piattaforma da bagno, Tavolo pozzetto, Teak deck, Teak pozzetto, Tender

**COMFORT:** Biancheria da letto, Cuscini per pozzetto, Cuscini prendisole per la tuga

**CUCINA:** Acqua calda, Congelatore, Fornello, Forno, Frigorifero, Utensili da cucina

**ELETTRAUTO YACHT:** Aria condizionata, Carica batterie, Dissalatori, Generatore, Inverter, Pannelli solari, Riscaldamento

**INTERIOR:** WC elettrici

**L'INTRATTENIMENTO:** Casse in pozzetto, Radio lettore CD, TV, Wet bar

**NAVIGAZIONE:** Autopilota, Carte nautiche, Elica di poppa, Elica di prua, GPS plotter cartografico - Pozzetto, Portolano, Tridata

**SICUREZZA:** Radio VHF

**VELE:** Electric primary winch

# PRICE AND AVAILABILITY

Hanse 588 Oceanelle (2024)



<b>13.06. - 20.06.2026</b> Not available	<b>20.06. - 27.06.2026</b> Not available	<b>27.06. - 04.07.2026</b> Not available	<b>04.07. - 11.07.2026</b> 7.552 € <del>9.440 €</del>
<b>11.07. - 18.07.2026</b> 7.552 € <del>9.440 €</del>	<b>18.07. - 01.08.2026</b> Not available	<b>01.08. - 08.08.2026</b> 7.952 € <del>9.940 €</del>	<b>08.08. - 15.08.2026</b> Not available
<b>15.08. - 22.08.2026</b> Not available	<b>22.08. - 29.08.2026</b> Not available	<b>29.08. - 05.09.2026</b> Not available	<b>05.09. - 12.09.2026</b> Not available
<b>12.09. - 26.09.2026</b> Not available	<b>26.09. - 03.10.2026</b> Not available	<b>03.10. - 10.10.2026</b> 4.656 € <del>5.820 €</del>	<b>10.10. - 17.10.2026</b> 4.336 € <del>5.420 €</del>
<b>17.10. - 24.10.2026</b> 4.336 € <del>5.420 €</del>	<b>24.10. - 31.10.2026</b> 4.928 € <del>6.160 €</del>	<b>31.10. - 07.11.2026</b> 4.928 € <del>6.160 €</del>	<b>07.11. - 14.11.2026</b> 4.928 € <del>6.160 €</del>
<b>14.11. - 21.11.2026</b> 4.928 € <del>6.160 €</del>	<b>21.11. - 28.11.2026</b> 4.928 € <del>6.160 €</del>	<b>28.11. - 05.12.2026</b> 4.928 € <del>6.160 €</del>	<b>05.12. - 12.12.2026</b> 4.928 € <del>6.160 €</del>
<b>12.12. - 19.12.2026</b> 4.928 € <del>6.160 €</del>	<b>19.12. - 26.12.2026</b> 4.928 € <del>6.160 €</del>	<b>02.01. - 09.01.2027</b> 3.408 € <del>4.260 €</del>	<b>09.01. - 16.01.2027</b> 3.408 € <del>4.260 €</del>
<b>16.01. - 23.01.2027</b> 3.408 € <del>4.260 €</del>	<b>23.01. - 30.01.2027</b> 3.408 € <del>4.260 €</del>	<b>30.01. - 06.02.2027</b> 3.408 € <del>4.260 €</del>	