

# BALI 4.1

Kanalu (2018)

Allure Navis D.O.O. • Antuna Branka Šimića 33 • 21000 Split • Croatia

Phone: +385 95 502 0094

Phone 2: +385 99 844 2210

E-mail: [info@allure-navis.com](mailto:info@allure-navis.com)

Web: [www.allure-navis.com](http://www.allure-navis.com)

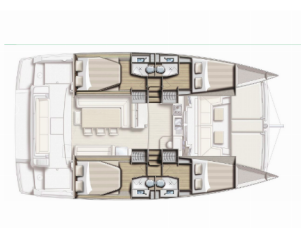

<b>Yacht Base</b>	Marina Kastela, Croazia
<b>Yacht ID</b>	5227
<b>Yacht Brands</b>	Catana
<b>Yacht Name</b>	Kanalu
<b>Production Year</b>	2018
<b>Length</b>	41 Ft
<b>Cabins</b>	4
<b>Berths</b>	8 + 2
<b>Max Persons</b>	10
<b>WC/Shower</b>	4

**ATTREZZATURE DI COPERTA:** Doccetta esterna, Flybridge, Forward cockpit, Piattaforma da bagno, Tavolo pozzetto, Tendalino, Tender, Varricello Salpancore

**COMFORT:** Biancheria da letto, Cuscini per pozzetto, Dom materassi

**CUCINA:** Acqua calda, Congelatore, Fornello, Forno, Frigorifero, Utensili da cucina

**ELETTRAUTO YACHT:** Carica batterie, Inverter, Pannelli solari

**INTERIOR:** WC elettrici

**L'INTRATTENIMENTO:** Casse in pozzetto, Radio CD mp3 player + USB

**NAVIGAZIONE:** Autopilota, Carte nautiche e nautica guida, GPS chart plotter, Portolano, Tridata

**SICUREZZA:** Radio VHF, Set di attrezzi

**VELE:** Electric primary winch

# PRICE AND AVAILABILITY

Bali 4.1 Kanalu (2018)

<b>13.06. - 20.06.2026</b> Not available	<b>20.06. - 27.06.2026</b> Not available	<b>27.06. - 04.07.2026</b> 4.176 € 5.220 €	<b>04.07. - 11.07.2026</b> Not available
<b>11.07. - 18.07.2026</b> Not available	<b>18.07. - 25.07.2026</b> Not available	<b>25.07. - 01.08.2026</b> Not available	<b>01.08. - 08.08.2026</b> Not available
<b>08.08. - 15.08.2026</b> Not available	<b>15.08. - 22.08.2026</b> Not available	<b>22.08. - 29.08.2026</b> Not available	<b>29.08. - 05.09.2026</b> Not available
<b>05.09. - 12.09.2026</b> Not available	<b>12.09. - 19.09.2026</b> Not available	<b>19.09. - 26.09.2026</b> Not available	<b>26.09. - 03.10.2026</b> 2.528 € 3.160 €
<b>03.10. - 10.10.2026</b> 1.856 € 2.320 €	<b>10.10. - 17.10.2026</b> 1.696 € 2.120 €	<b>17.10. - 24.10.2026</b> 1.616 € 2.020 €	<b>24.10. - 31.10.2026</b> 1.616 € 2.020 €
<b>31.10. - 07.11.2026</b> 1.616 € 2.020 €	<b>07.11. - 14.11.2026</b> 1.616 € 2.020 €	<b>14.11. - 21.11.2026</b> 1.616 € 2.020 €	<b>21.11. - 28.11.2026</b> 1.616 € 2.020 €
<b>28.11. - 05.12.2026</b> 1.616 € 2.020 €	<b>05.12. - 12.12.2026</b> 1.616 € 2.020 €	<b>12.12. - 19.12.2026</b> 1.616 € 2.020 €	<b>19.12. - 26.12.2026</b> 1.616 € 2.020 €
<b>02.01. - 09.01.2027</b> 1.696 € 2.120 €	<b>09.01. - 16.01.2027</b> 1.696 € 2.120 €	<b>16.01. - 23.01.2027</b> 1.696 € 2.120 €	<b>23.01. - 30.01.2027</b> 1.696 € 2.120 €
<b>30.01. - 06.02.2027</b> 1.696 € 2.120 €			