

LEOPARD 45

Dou Reve V (2022)

Allure Navis D.O.O. • Antuna Branka Šimića 33 • 21000 Split • Croatia

Phone: +385 95 502 0094

Phone 2: +385 99 844 2210

E-mail: info@allure-navis.com

Web: www.allure-navis.com

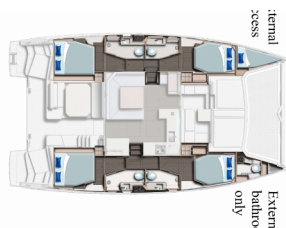

Yacht Base	Sardinia, Cannigione, Italy
Yacht ID	9946
Yacht Brands	Leopard
Yacht Name	Dou Reve V
Production Year	2022
Length	45 Ft
Cabins	4 + 1
Berths	8 + 2 + 1
WC/Shower	4 + 1

COMFORT: Pillows

DECK: Anchor with chain, Bilge pump - Mechanic, Bimini top, Boat hook, Bosun's chair (Safe seat)(boatswain's chair), Deck brush, Electric anchor windlass, Fenders, Flybridge, Fuel funnel, Gangway, Mooring ropes, Outboard engine, Plastic bucket, Spare anchor (Reserve, Auxiliary anchor), Swimming ladder, Tender, Water hose, Winch handles

ENTERTAINMENT: CD player, Fins, Outdoor speakers

GALLEY: Coffee machine, Gas bottles, Hot water, Kitchen utensils (Galley equipment, cutlery), Oven, Refrigerator, Stove

INTERIOR: Barometer, Clock, Water Purifier

NAVIGATION: Autopilot, Binoculars, Echosounder/Depthsounder, GPS chart plotter, Hand bearing compass, Log, Nautical charts, Pilot book, Radar reflector, Wind instrument/Anemometer

SAFETY: Buoyant smoke signal, Distress flare box, Emergency tiller, Fire extinguisher, First aid kit, Fog horn, Horseshoe lifebuoy, Life belts (Safety harness), Life jackets, Liferaft, Repair kit, Torch, VHF radio

SAILS: Electric winch

YACHT ELECTRICS: Air Conditioning, Bilge pump - Electric, Generator, Inverter, Solar panels, Watermaker - desalinator

PRICE AND AVAILABILITY

Leopard 45 Dou Reve V (2022)



04.07. - 11.07.2026 Not available	11.07. - 18.07.2026 Not available	18.07. - 25.07.2026 Not available	25.07. - 01.08.2026 Not available
01.08. - 08.08.2026 Not available	08.08. - 15.08.2026 Not available	15.08. - 22.08.2026 9.840 € 12.300 €	22.08. - 29.08.2026 Not available
29.08. - 05.09.2026 Not available	05.09. - 12.09.2026 Not available	12.09. - 19.09.2026 7.920 € 9.900 €	19.09. - 26.09.2026 Not available
26.09. - 03.10.2026 Not available	03.10. - 10.10.2026 Not available	10.10. - 17.10.2026 5.120 € 6.400 €	17.10. - 24.10.2026 5.120 € 6.400 €
24.10. - 31.10.2026 5.120 € 6.400 €	31.10. - 07.11.2026 5.120 € 6.400 €	07.11. - 14.11.2026 5.120 € 6.400 €	14.11. - 21.11.2026 5.120 € 6.400 €
21.11. - 28.11.2026 5.120 € 6.400 €	28.11. - 05.12.2026 5.120 € 6.400 €	05.12. - 12.12.2026 5.120 € 6.400 €	12.12. - 19.12.2026 5.120 € 6.400 €
19.12. - 26.12.2026 5.120 € 6.400 €			