

# SUN ODYSSEY 380

4 Elli (2023)



Allure Navis D.O.O. • Antuna Branka Šimića 33 • 21000 Split • Croatia

Phone: +385 95 502 0094

Phone 2: +385 99 844 2210

E-mail: [info@allure-navis.com](mailto:info@allure-navis.com)

Web: [www.allure-navis.com](http://www.allure-navis.com)

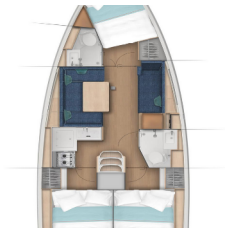

<b>Yacht Base</b>	Palma De Mallorca, La Lonja, Spain
<b>Yacht ID</b>	9621
<b>Yacht Brands</b>	Jeanneau
<b>Yacht Name</b>	4 Elli
<b>Production Year</b>	2023
<b>Length</b>	37 Ft
<b>Cabins</b>	3
<b>Berths</b>	6 + 2
<b>Max Persons</b>	8
<b>WC/Shower</b>	2

**COMFORT:** Cockpit cushions

**DECK:** Anchor, Bathing platform, Bimini top, Bosun's chair (Safe seat)(boatswain's chair), Cockpit table, Cockpit/stern, outside shower, Dinghy, Electric anchor windlass, Fenders, Gangway, Ropes, Sprayhood, Swimming ladder, Teak cockpit, Water hose

**ENTERTAINMENT:** Outdoor speakers, Radio mp3 player

**GALLEY:** Gas bottles, Hot water, Kitchen utensils (Galley equipment, cutlery), Refrigerator, Stove

**INTERIOR:** Barometer, Clock, Electric fans

**NAVIGATION:** AIS, Autopilot, Binoculars, Bow thruster, Cockpit control panel, Compass, Echosounder/Depthsounder, GPS chart plotter, Hand bearing compass, Harbour guides, LED Navigation lights, List of lights, Log, Nautical charts, Pilot book, Radar reflector, Speedometer (Speed log), Wind instrument/Anemometer, Windex

**SAFETY:** Automatic Inflatable Life Jacket, Black Water Tank, Distress flare box, Distress signals, Emergency tiller, EPIRB-Distress radio beacons, Fire extinguisher, First aid kit, Floating light, Fog horn, GMDSS - Global Maritime Distress and Safety System, Horseshoe lifebuoy, Inflatable life raft, Life belts (Safety harness), Life jackets, Set of tools

**YACHT ELECTRICS:** Battery charger, Bilge pump - Electric, Heating, Inverter, Plug 220V, 12 V, Solar panels

# PRICE AND AVAILABILITY

Sun Odyssey 380 4 Elli (2023)



<b>13.06. - 20.06.2026</b> Not available	<b>20.06. - 27.06.2026</b> Not available	<b>27.06. - 04.07.2026</b> Not available	<b>04.07. - 11.07.2026</b> Not available
<b>11.07. - 18.07.2026</b> Not available	<b>18.07. - 25.07.2026</b> Not available	<b>25.07. - 01.08.2026</b> Not available	<b>01.08. - 08.08.2026</b> Not available
<b>08.08. - 15.08.2026</b> Not available	<b>15.08. - 22.08.2026</b> 3.771 € <del>4.190 €</del>	<b>22.08. - 29.08.2026</b> Not available	<b>29.08. - 05.09.2026</b> 3.501 € <del>3.890 €</del>
<b>05.09. - 12.09.2026</b> Not available	<b>12.09. - 19.09.2026</b> 3.141 € <del>3.490 €</del>	<b>19.09. - 26.09.2026</b> Not available	<b>26.09. - 03.10.2026</b> 2.970 € <del>3.300 €</del>
<b>03.10. - 10.10.2026</b> 2.574 € <del>2.860 €</del>	<b>10.10. - 17.10.2026</b> 2.574 € <del>2.860 €</del>	<b>17.10. - 24.10.2026</b> 2.187 € <del>2.430 €</del>	<b>24.10. - 31.10.2026</b> 2.187 € <del>2.430 €</del>
<b>31.10. - 07.11.2026</b> 1.872 € <del>2.080 €</del>	<b>07.11. - 14.11.2026</b> 2.080 €	<b>14.11. - 21.11.2026</b> 1.820 €	<b>21.11. - 28.11.2026</b> 1.820 €
<b>28.11. - 05.12.2026</b> 1.820 €	<b>05.12. - 12.12.2026</b> 1.820 €	<b>12.12. - 19.12.2026</b> 1.820 €	<b>19.12. - 26.12.2026</b> 1.820 €
<b>26.12. - 09.01.2027</b> Not available	<b>09.01. - 16.01.2027</b> 2.142 €	<b>16.01. - 23.01.2027</b> 2.142 €	<b>23.01. - 30.01.2027</b> 2.142 €
<b>30.01. - 06.02.2027</b> 2.142 €			