

# NAUTITECH 40 OPEN NEW

*Whale Symphony (2018)*



---

**Allure Navis D.O.O. • Antuna Branka Šimića 33 • 21000 Split • Croatia**

Phone: +385 95 502 0094

Phone 2: +385 99 844 2210

E-mail: [info@allure-navis.com](mailto:info@allure-navis.com)

Web: [www.allure-navis.com](http://www.allure-navis.com)

---

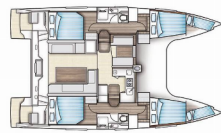

<b>Yacht Base</b>	Tribunj D-Marin, Croatia
<b>Yacht ID</b>	8691
<b>Yacht Brands</b>	Bavaria
<b>Yacht Name</b>	Whale Symphony
<b>Production Year</b>	2018
<b>Length</b>	39 Ft
<b>Cabins</b>	4 + 2
<b>Berths</b>	8 + 2
<b>WC/Shower</b>	2

**COMFORT:** Bed linen, Cockpit cushions

**DECK:** Anchor line, Anchor swivel, Bathing platform, Bimini top, Black ball, Black conus, Boat hook, Bosun's chair (Safe seat) (boatswain's chair), Canister for water, Chairs, Cockpit full tent, Cockpit table, Cockpit/stern, outside shower, Davit, Dinghy, Dinghy (byboat) pump, Electric anchor windlass, Fenders, Gangway, Hawser, Impeller, V-belt, oilfilter, Jerry cans for diesel, Main anchor, Mooring ropes, Plastic bucket, Remote control for anchor winch with chain counter at helm, Repair box for dinghy, Round/globular fender, Spare anchor (Reserve, Auxiliary anchor), Spotlight / Headlights, Spring line, Water hose

**ENTERTAINMENT:** Outdoor speakers, Radio, Wi-Fi Internet

**GALLEY:** Hot water, Kitchen utensils (Galley equipment, cutlery), Refrigerator

**INTERIOR:** Barometer, Clock, Electric fans in cabins, Electric toilet, Inside shower

**NAVIGATION:** 3 blade folding propeller, AIS, Autopilot, Binoculars with integrated compass, GPS chart plotter - cockpit, Harbour guides, Logge/Lot/Speed/Wind, Navigation (Nautical) charts and nautical guide, Navigation set, Radar, Radar reflector

**SAFETY:** Distress flare box, Fire extinguisher, First aid kit, Flashlight, Fog horn, Life belts (Safety harness), Life buoy + Flashing light, Lifteraft, Self inflating life vest, Set of tools, VHF radio, Wire (shroud) cutter

**SAILS:** Electric winch, Gennaker-device, Lazy bag, Lazy jacks

**YACHT ELECTRICS:** Battery charger, Heating, Inverter, Shore connection 220 V, Solar panels

# PRICE AND AVAILABILITY

Nautitech 40 Open NEW Whale Symphony (2018)



<b>23.04. - 26.04.2026</b> Not available	<b>02.05. - 09.05.2026</b> 1.140 € 2.000€	<b>09.05. - 16.05.2026</b> 1.150 € 2.300€	<b>16.05. - 23.05.2026</b> 1.664 € 2.600€
<b>23.05. - 30.05.2026</b> Not available	<b>30.05. - 06.06.2026</b> Not available	<b>06.06. - 13.06.2026</b> Not available	<b>13.06. - 20.06.2026</b> 3.268 € 4.300€
<b>20.06. - 27.06.2026</b> 3.575 € 5.500€	<b>27.06. - 04.07.2026</b> Not available	<b>04.07. - 11.07.2026</b> 3.894 € 5.900€	<b>11.07. - 18.07.2026</b> 4.130 € 5.900€
<b>18.07. - 25.07.2026</b> Not available	<b>25.07. - 01.08.2026</b> 4.221 € 6.700€	<b>01.08. - 08.08.2026</b> 4.154 € 6.700€	<b>08.08. - 15.08.2026</b> 4.154 € 6.700€
<b>15.08. - 22.08.2026</b> 3.886 € 6.700€	<b>22.08. - 29.08.2026</b> 3.819 € 6.700€	<b>29.08. - 05.09.2026</b> 3.416 € 6.100€	<b>05.09. - 12.09.2026</b> 3.540 € 5.900€
<b>12.09. - 19.09.2026</b> 4.080 € 5.100€	<b>19.09. - 26.09.2026</b> Not available	<b>26.09. - 03.10.2026</b> On option	<b>03.10. - 10.10.2026</b> On option
<b>10.10. - 17.10.2026</b> Not available	<b>17.10. - 24.10.2026</b> 1.335 € 1.500€	<b>31.10. - 31.12.2026</b> Not available	