

# BALI 4.2 OW

*Elifcim (2022)*



---

**Allure Navis D.O.O. • Antuna Branka Šimića 33 • 21000 Split • Croatia**

Phone: +385 95 502 0094

Phone 2: +385 99 844 2210

E-mail: [info@allure-navis.com](mailto:info@allure-navis.com)

Web: [www.allure-navis.com](http://www.allure-navis.com)

---

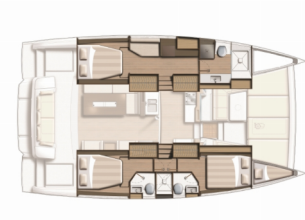

<b>Yacht Base</b>	Göcek, Turkey
<b>Yacht ID</b>	7736
<b>Yacht Brands</b>	Catana
<b>Yacht Name</b>	Elifcim
<b>Production Year</b>	2022
<b>Length</b>	42 Ft
<b>Cabins</b>	3 + 1
<b>Berths</b>	6
<b>Max Persons</b>	7
<b>WC/Shower</b>	3 + 1

**ADDITIONAL:** Flag

**COMFORT:** Blankets, Cockpit cushions, Pillows, Sun mattresses

**DECK:** Anchor with chain, Bilge pump - Mechanic, Bimini top, Black ball, Boat hook, Bosun's chair (Safe seat)(boatswain's chair), Canister for water, Cockpit light, Cockpit table, Cockpit/stern, outside shower, Davit, Deck brush, Dinghy (byboat) pump, Electric anchor windlass, Fenders, Flybridge, Fuel funnel, Gangway, Grill/Barbecue/Plancha, Impeller, V-belt, oilfilter, Jerry cans for diesel, Jerry cans for fuel, Mooring ropes, Plastic bucket, Repair box for dinghy, Round/globular fender, Spare anchor (Reserve, Auxiliary anchor), Sponge, Spring line, Swimming ladder, Water hose, Winch handles

**ENTERTAINMENT:** Mask and snorkel, Outdoor speakers

**GALLEY:** Dishwashing liquid, Gas bottles, Gas cookers, Hot water, Kitchen utensils (Galley equipment, cutlery), Microwave, Oven, Pressurized water system, Refrigerator, Sink

**INTERIOR:** Barometer, Clock, Convertible table in salon, Electric fans in cabins, Electric toilet

**NAVIGATION:** Autopilot, Binoculars, Compass, GPS chart plotter - cockpit, Hand bearing compass, Log, Nautical charts, Navigation (Nautical) charts and nautical guide, Navigation set, Radar reflector, Wind instrument/Anemometer, Windex

**SAFETY:** Black Water Tank, Distress signals, Emergency tiller, Fire blanket, Fire extinguisher, First aid kit, Fog horn, Life belts (Safety harness), Life buoy + Flashing light, Life jacket (children), Life jackets, Liferaft, Oars (Paddles), Repair kit, Search light, Set of tools, Sos Dan Buoy, Spare parts, Torch, VHF radio, Wire (shroud) cutter

**SAILS:** Electric main sail winch

**YACHT ELECTRICS:** Air Conditioning, Battery charger, Bilge pump - Electric, Generator, Inverter, Plug 220V, 12 V, Service batteries, Solar panels, Start battery, Watermaker - desalinator

# PRICE AND AVAILABILITY

Bali 4.2 OW Elifcim (2022)



<b>18.04. - 25.04.2026</b> 4.500 € <del>5.000 €</del>	<b>30.04. - 04.05.2026</b> Not available	<b>09.05. - 16.05.2026</b> 6.525 € <del>7.250 €</del>	<b>16.05. - 23.05.2026</b> 6.525 € <del>7.250 €</del>
<b>23.05. - 30.05.2026</b> 7.245 € <del>8.050 €</del>	<b>30.05. - 06.06.2026</b> Not available	<b>06.06. - 13.06.2026</b> 7.920 € <del>8.800 €</del>	<b>13.06. - 20.06.2026</b> 7.920 € <del>8.800 €</del>
<b>20.06. - 27.06.2026</b> 7.920 € <del>8.800 €</del>	<b>27.06. - 04.07.2026</b> 6.525 € <del>7.250 €</del>	<b>04.07. - 11.07.2026</b> Not available	<b>11.07. - 18.07.2026</b> 6.525 € <del>7.250 €</del>
<b>18.07. - 25.07.2026</b> Not available	<b>25.07. - 01.08.2026</b> Not available	<b>01.08. - 08.08.2026</b> 7.245 € <del>8.050 €</del>	<b>08.08. - 22.08.2026</b> Not available
<b>22.08. - 29.08.2026</b> 7.245 € <del>8.050 €</del>	<b>29.08. - 05.09.2026</b> 7.920 € <del>8.800 €</del>	<b>05.09. - 12.09.2026</b> Not available	<b>12.09. - 19.09.2026</b> 8.550 € <del>9.500 €</del>
<b>19.09. - 26.09.2026</b> Not available	<b>26.09. - 03.10.2026</b> 8.550 € <del>9.500 €</del>	<b>03.10. - 10.10.2026</b> 8.550 € <del>9.500 €</del>	<b>10.10. - 17.10.2026</b> 8.550 € <del>9.500 €</del>
<b>17.10. - 24.10.2026</b> 8.550 € <del>9.500 €</del>	<b>24.10. - 31.10.2026</b> 7.245 € <del>8.050 €</del>	<b>31.10. - 07.11.2026</b> 7.245 € <del>8.050 €</del>	<b>07.11. - 14.11.2026</b> 4.500 € <del>5.000 €</del>
<b>14.11. - 21.11.2026</b> 4.500 € <del>5.000 €</del>	<b>21.11. - 28.11.2026</b> 4.500 € <del>5.000 €</del>	<b>28.11. - 05.12.2026</b> 4.500 € <del>5.000 €</del>	

# PRICE AND AVAILABILITY

Bali 4.2 OW Elifcim (2022)



**05.12. - 12.12.2026**

4.500 € ~~5.000 €~~

**12.12. - 19.12.2026**

4.500 € ~~5.000 €~~

**19.12. - 26.12.2026**

4.500 € ~~5.000 €~~