

# BALI 4.5

Sylvester (2019)

Allure Navis D.O.O. • Antuna Branka Šimića 33 • 21000 Split • Croatia

Phone: +385 95 502 0094

Phone 2: +385 99 844 2210

E-mail: [info@allure-navis.com](mailto:info@allure-navis.com)

Web: [www.allure-navis.com](http://www.allure-navis.com)

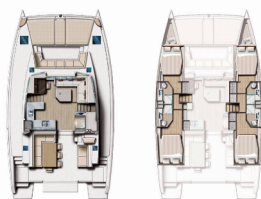

**DECK:** Anchor, Anchor with chain, Bimini top, Cockpit full tent, Cockpit/stern, outside shower, Dinghy, Electric anchor windlass, Floating rope, Grill/Barbecue/Plancha, Main anchor, Spare anchor (Reserve, Auxiliary anchor)

**ENTERTAINMENT:** Radio CD player, TV

**GALLEY:** Hot water, Sink

**NAVIGATION:** Autopilot, Depthsounder, GPS chart plotter, Log/speed instrument, Wind instrument/Anemometer

**SAFETY:** Distress flare box, Fire extinguisher, First aid kit, Life belts (Safety harness), Life buoy + Flashing light, Liferaft, Sos Dan Buoy

**SAILS:** Electric halyard winch, Lazy bag, Lazy jacks

**YACHT ELECTRICS:** Air Conditioning, Generator, Heating, Inverter, Service batteries, Shore connection 220 V, Shore power cable, Solar panels, Start battery

<b>Yacht Base</b>	Marina Mandalina, Sibenik, Croatia
<b>Yacht ID</b>	5447
<b>Yacht Brands</b>	Catana
<b>Yacht Name</b>	Sylvester
<b>Production Year</b>	2019
<b>Length</b>	45 Ft
<b>Cabins</b>	4 + 2
<b>Berths</b>	8 + 2 + 2
<b>Max Persons</b>	12
<b>WC/Shower</b>	4

# PRICE AND AVAILABILITY

Bali 4.5 Sylvester (2019)



<b>18.04. - 25.04.2026</b> 2.352 € <del>2.940 €</del>	<b>25.04. - 02.05.2026</b> 2.368 € <del>2.960 €</del>	<b>02.05. - 09.05.2026</b> 2.368 € <del>2.960 €</del>	<b>09.05. - 16.05.2026</b> 2.704 € <del>3.380 €</del>
<b>16.05. - 23.05.2026</b> 3.056 € <del>3.820 €</del>	<b>23.05. - 30.05.2026</b> 4.336 € <del>5.420 €</del>	<b>30.05. - 06.06.2026</b> Not available	<b>06.06. - 20.06.2026</b> Not available
<b>20.06. - 02.07.2026</b> Not available	<b>04.07. - 11.07.2026</b> Not available	<b>11.07. - 18.07.2026</b> 7.744 € <del>9.680 €</del>	<b>18.07. - 25.07.2026</b> Not available
<b>25.07. - 01.08.2026</b> 8.624 € <del>10.780 €</del>	<b>01.08. - 08.08.2026</b> 8.624 € <del>10.780 €</del>	<b>08.08. - 15.08.2026</b> Not available	<b>15.08. - 22.08.2026</b> Not available
<b>22.08. - 29.08.2026</b> Not available	<b>29.08. - 05.09.2026</b> 6.592 € <del>8.240 €</del>	<b>05.09. - 12.09.2026</b> Not available	<b>12.09. - 19.09.2026</b> Not available
<b>19.09. - 26.09.2026</b> Not available	<b>26.09. - 03.10.2026</b> 3.696 € <del>4.620 €</del>	<b>03.10. - 10.10.2026</b> 2.976 € <del>3.720 €</del>	<b>10.10. - 17.10.2026</b> 2.656 € <del>3.320 €</del>
<b>17.10. - 24.10.2026</b> 2.496 € <del>3.120 €</del>	<b>24.10. - 31.10.2026</b> 2.496 € <del>3.120 €</del>	<b>31.10. - 07.11.2026</b> 2.496 € <del>3.120 €</del>	<b>07.11. - 14.11.2026</b> 2.496 € <del>3.120 €</del>
<b>14.11. - 21.11.2026</b> 2.496 € <del>3.120 €</del>	<b>21.11. - 28.11.2026</b> 2.496 € <del>3.120 €</del>	<b>28.11. - 05.12.2026</b> 2.496 € <del>3.120 €</del>	

# PRICE AND AVAILABILITY

Bali 4.5 Sylvester (2019)



**05.12. - 12.12.2026**

2.496 € ~~3.120 €~~

**12.12. - 19.12.2026**

2.496 € ~~3.120 €~~

**19.12. - 26.12.2026**

2.496 € ~~3.120 €~~