

BAVARIA CRUISER 41

MH 58 (2016)



Allure Navis D.O.O. • Antuna Branka Šimića 33 • 21000 Split • Croatia

Phone: +385 95 502 0094

Phone 2: +385 99 844 2210

E-mail: info@allure-navis.com

Web: www.allure-navis.com

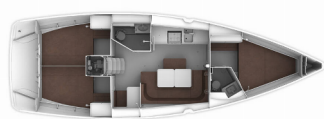

| | |
|------------------------|---------------------------------|
| Yacht Base | Marina Hramina, Murter, Croatia |
| Yacht ID | 498 |
| Yacht Brands | Bavaria |
| Yacht Name | MH 58 |
| Production Year | 2016 |
| Length | 41 Ft |
| Cabins | 3 |
| Berths | 6 + 1 |
| Max Persons | 7 |
| WC/Shower | 2 |

COMFORT: Bed linen, Blankets, Pillows, Towels

DECK: Anchor with chain, Bathing platform, Bilge pump - Mechanic, Bimini top, Boat hook, Bosun's chair (Safe seat) (boatswain's chair), Cockpit table, Cockpit/stern, outside shower, Deck brush, Dinghy, Electric anchor windlass, Fenders, Fuel funnel, Gangway, Impeller, Jerry cans for diesel, Main Deck Compass, Mooring ropes, Plastic bucket, Reserve motor oil, Sprayhood, Swimming ladder, Teak cockpit, Water hose, Winch handles

ENTERTAINMENT: DVD player, LCD TV, Radio CD player

GALLEY: Gas bottles, Gas cookers, Hot water, Kitchen utensils (Galley equipment, cutlery), Oven, Refrigerator, Sink, Water pump

INTERIOR: Barometer, Thermometer, Toilet paper

NAVIGATION: Autopilot, Binoculars, Bow thruster, GPS chart plotter, Hand bearing compass, Log, Speed, Depth- echo sounder, Navigation (Nautical) charts and nautical guide, Navigation set, Pilot book, Wind instrument/Anemometer

SAFETY: Distress signals, Emergency tiller, Fire extinguisher, First aid kit, Fog horn, Life belts (Safety harness), Life buoy + Flashing light, Life jackets, Oars (Paddles), Search light, Set of tools, Spare parts, Torch, VHF radio

YACHT ELECTRICS: Batteries, Battery charger, Bilge pump - Electric, Heating, Plug 220V, 12 V, Pump, Shore connection 220 V, Start battery

PRICE AND AVAILABILITY

Bavaria Cruiser 41 MH 58 (2016)



| | | | |
|--|--|--|--|
| 18.04. - 25.04.2026 1.950 € 2.600 € | 25.04. - 02.05.2026 2.175 € 2.900 € | 02.05. - 09.05.2026 2.175 € 2.900 € | 09.05. - 16.05.2026 2.175 € 2.900 € |
| 16.05. - 23.05.2026 2.175 € 2.900 € | 23.05. - 30.05.2026 2.175 € 2.900 € | 30.05. - 06.06.2026 2.310 € 3.300 € | 06.06. - 13.06.2026 2.310 € 3.300 € |
| 13.06. - 20.06.2026 2.310 € 3.300 € | 20.06. - 27.06.2026 1.980 € 3.300 € | 27.06. - 04.07.2026 1.980 € 3.300 € | 04.07. - 11.07.2026 2.100 € 3.500 € |
| 11.07. - 18.07.2026 2.100 € 3.500 € | 18.07. - 25.07.2026 2.100 € 3.500 € | 25.07. - 01.08.2026 2.100 € 3.500 € | 01.08. - 08.08.2026 2.100 € 3.500 € |
| 08.08. - 15.08.2026 2.100 € 3.500 € | 15.08. - 22.08.2026 1.980 € 3.300 € | 22.08. - 29.08.2026 1.980 € 3.300 € | 29.08. - 05.09.2026 1.980 € 3.300 € |
| 05.09. - 12.09.2026 On option | 12.09. - 19.09.2026 2.465 € 2.900 € | 19.09. - 26.09.2026 2.465 € 2.900 € | 26.09. - 03.10.2026 2.210 € 2.600 € |
| 03.10. - 10.10.2026 2.210 € 2.600 € | 10.10. - 17.10.2026 1.615 € 1.900 € | 17.10. - 20.10.2026 Not available | 24.10. - 31.10.2026 1.615 € 1.900 € |
| 31.10. - 07.11.2026 1.615 € 1.900 € | 07.11. - 14.11.2026 1.615 € 1.900 € | 14.11. - 21.11.2026 1.615 € 1.900 € | 21.11. - 28.11.2026 1.615 € 1.900 € |
| 28.11. - 05.12.2026 1.615 € 1.900 € | | | |

PRICE AND AVAILABILITY

Bavaria Cruiser 41 MH 58 (2016)



| | | | |
|--|--|--|--|
| 05.12. - 12.12.2026 1.615 € 1.900 € | 12.12. - 19.12.2026 1.615 € 1.900 € | 19.12. - 26.12.2026 1.615 € 1.900 € | 02.01. - 09.01.2027 1.615 € 1.900 € |
| 09.01. - 16.01.2027 1.615 € 1.900 € | 16.01. - 23.01.2027 1.615 € 1.900 € | 23.01. - 30.01.2027 1.615 € 1.900 € | 30.01. - 06.02.2027 1.615 € 1.900 € |
| 06.02. - 13.02.2027 1.615 € 1.900 € | 13.02. - 20.02.2027 1.615 € 1.900 € | 20.02. - 27.02.2027 1.615 € 1.900 € | 27.02. - 06.03.2027 1.615 € 1.900 € |
| 06.03. - 13.03.2027 1.615 € 1.900 € | 13.03. - 20.03.2027 1.615 € 1.900 € | 20.03. - 27.03.2027 1.615 € 1.900 € | 27.03. - 03.04.2027 1.615 € 1.900 € |
| 03.04. - 10.04.2027 2.210 € 2.600 € | 10.04. - 17.04.2027 2.210 € 2.600 € | 17.04. - 24.04.2027 2.210 € 2.600 € | 24.04. - 01.05.2027 2.465 € 2.900 € |
| 01.05. - 08.05.2027 2.465 € 2.900 € | 08.05. - 15.05.2027 2.465 € 2.900 € | 15.05. - 22.05.2027 2.465 € 2.900 € | 22.05. - 29.05.2027 2.465 € 2.900 € |
| 29.05. - 05.06.2027 2.805 € 3.300 € | 05.06. - 12.06.2027 2.805 € 3.300 € | 12.06. - 19.06.2027 2.805 € 3.300 € | 19.06. - 26.06.2027 2.805 € 3.300 € |
| 26.06. - 03.07.2027 2.805 € 3.300 € | 03.07. - 10.07.2027 2.975 € 3.500 € | 10.07. - 17.07.2027 2.975 € 3.500 € | 17.07. - 24.07.2027 2.975 € 3.500 € |
| 24.07. - 31.07.2027 2.975 € 3.500 € | 31.07. - 07.08.2027 2.975 € 3.500 € | | |