

# BAVARIA CRUISER 46

Sea Legend (2024)



Allure Navis D.O.O. • Antuna Branka Šimića 33 • 21000 Split • Croatia

Phone: +385 95 502 0094

Phone 2: +385 99 844 2210

E-mail: [info@allure-navis.com](mailto:info@allure-navis.com)

Web: [www.allure-navis.com](http://www.allure-navis.com)

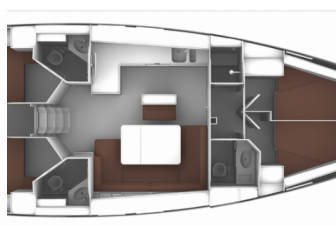

|                        |                            |
|------------------------|----------------------------|
| <b>Yacht Base</b>      | Marina Punat, Krk, Croatia |
| <b>Yacht ID</b>        | 4953                       |
| <b>Yacht Brands</b>    | Bavaria                    |
| <b>Yacht Name</b>      | Sea Legend                 |
| <b>Production Year</b> | 2024                       |
| <b>Length</b>          | 46 Ft                      |
| <b>Cabins</b>          | 4                          |
| <b>Berths</b>          | 8 + 1                      |
| <b>Max Persons</b>     | 10                         |
| <b>WC/Shower</b>       | 3                          |

**DECK:** Anchor with chain, Bathing platform, Bilge pump -  
Mechanic, Bimini top, Teak cockpit

**ENTERTAINMENT:** FUSION sound system, Indoor speakers,  
Outdoor speakers

**GALLEY:** Freezer, Gas bottles, Refrigerator, Stove, Water pump

**INTERIOR:** Electric toilet, Salon table

**NAVIGATION:** Autopilot, Bow thruster, Navigation set, Windex

**SAFETY:** VHF radio

**SAILS:** Winch

**YACHT ELECTRICS:** Air Conditioning, Batteries, Bilge pump -  
Electric, Heating, Service batteries, Shore power connection,  
Solar panels, Water heater

# PRICE AND AVAILABILITY

Bavaria Cruiser 46 Sea Legend (2024)



|  |  |  |  |
|--|--|--|--|
| <b>13.06. - 20.06.2026</b><br>Not available              | <b>20.06. - 27.06.2026</b><br>2.571 € <del>4.850 €</del> | <b>27.06. - 04.07.2026</b><br>Not available              | <b>04.07. - 11.07.2026</b><br>Not available              |
| <b>11.07. - 18.07.2026</b><br>Not available              | <b>18.07. - 25.07.2026</b><br>3.434 € <del>5.450 €</del> | <b>25.07. - 01.08.2026</b><br>3.434 € <del>5.450 €</del> | <b>01.08. - 08.08.2026</b><br>Not available              |
| <b>08.08. - 22.08.2026</b><br>Not available              | <b>22.08. - 29.08.2026</b><br>Not available              | <b>29.08. - 05.09.2026</b><br>Not available              | <b>05.09. - 12.09.2026</b><br>Not available              |
| <b>12.09. - 19.09.2026</b><br>Not available              | <b>19.09. - 26.09.2026</b><br>Not available              | <b>26.09. - 03.10.2026</b><br>Not available              | <b>03.10. - 10.10.2026</b><br>Not available              |
| <b>10.10. - 17.10.2026</b><br>1.495 € <del>2.300 €</del> | <b>17.10. - 24.10.2026</b><br>1.334 € <del>2.300 €</del> | <b>24.10. - 31.10.2026</b><br>1.334 € <del>2.300 €</del> | <b>31.10. - 07.11.2026</b><br>1.334 € <del>2.300 €</del> |
| <b>08.11. - 31.12.2026</b><br>Not available              | <b>02.01. - 09.01.2027</b><br>2.070 €                    | <b>09.01. - 16.01.2027</b><br>2.070 €                    | <b>16.01. - 23.01.2027</b><br>2.070 €                    |
| <b>23.01. - 30.01.2027</b><br>2.070 €                    | <b>30.01. - 06.02.2027</b><br>2.070 €                    |  |  |