

# LAGOON 40

Mars (2020)

Allure Navis D.O.O. • Antuna Branka Šimića 33 • 21000 Split • Croatia

Phone: +385 95 502 0094

Phone 2: +385 99 844 2210

E-mail: [info@allure-navis.com](mailto:info@allure-navis.com)

Web: [www.allure-navis.com](http://www.allure-navis.com)

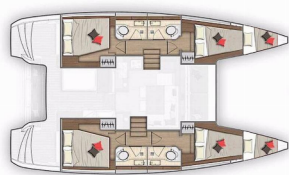

|                        |                            |
|------------------------|----------------------------|
| <b>Yacht Base</b>      | ACI Marina Vodice, Croatia |
| <b>Yacht ID</b>        | 3402                       |
| <b>Yacht Brands</b>    | Lagoon                     |
| <b>Yacht Name</b>      | Mars                       |
| <b>Production Year</b> | 2020                       |
| <b>Length</b>          | 39 Ft                      |
| <b>Cabins</b>          | 4 + 2                      |
| <b>Berths</b>          | 8 + 2 + 2                  |
| <b>Max Persons</b>     | 12                         |
| <b>WC/Shower</b>       | 4                          |

**COMFORT:** Bed linen, Cockpit cushions, Pillows

**DECK:** Bilge pump - Mechanic, Bimini top, Boat hook, Cockpit table, Cockpit/stern, outside shower, Electric anchor windlass, Fenders, Gangway, Main anchor, Mooring ropes, Spare anchor (Reserve, Auxiliary anchor), Sun deck, Swimming ladder, Teak cockpit, Water hose, Winch handles

**ENTERTAINMENT:** Fusion radio, Indoor speakers, Outdoor speakers, Wi-Fi Internet

**GALLEY:** Electrical kettle, Gas bottles, Gas cookers, Hot water, Kitchen utensils (Galley equipment, cutlery), Moka pot, Oven, Refrigerator, Sink

**INTERIOR:** Barometer, Clock, Duvet cover, Electric fans in cabins

**NAVIGATION:** Autopilot, Binoculars, Compass, Divider, nautic chart, GPS chart plotter - cockpit, Hand bearing compass, Helm station, Navigation (Nautical) charts and nautical guide, Navigation set, Radar reflector, Tridata, Wind instrument/Anemometer

**SAFETY:** Black Water Tank, Distress flare box, Emergency tiller, Fire extinguisher, First aid kit, Flashlight, Fog horn, Life belts (Safety harness), Life buoy + Flashing light, Life jackets, Liferaft, Repair kit, Set of tools, VHF radio

**SAILS:** Lazy bag

**YACHT ELECTRICS:** 220V socket, Battery charger, Bilge pump - Electric, Heating, Pump, Service batteries, Shore connection 220 V, Shore power cable, Solar panels

# PRICE AND AVAILABILITY

Lagoon 40 Mars (2020)



|  |  |  |  |
|--|--|--|--|
| <b>18.04. - 25.04.2026</b><br>1.140 € 1.900€ | <b>25.04. - 02.05.2026</b><br>1.268 € 1.950€ | <b>02.05. - 09.05.2026</b><br>1.365 € 2.100€ | <b>09.05. - 16.05.2026</b><br>1.530 € 2.550€ |
| <b>16.05. - 23.05.2026</b><br>Not available  | <b>23.05. - 30.05.2026</b><br>2.460 € 4.100€ | <b>30.05. - 06.06.2026</b><br>Not available  | <b>06.06. - 13.06.2026</b><br>Not available  |
| <b>13.06. - 20.06.2026</b><br>3.315 € 5.100€ | <b>20.06. - 27.06.2026</b><br>Not available  | <b>27.06. - 04.07.2026</b><br>On option      | <b>04.07. - 11.07.2026</b><br>4.888 € 5.750€ |
| <b>11.07. - 18.07.2026</b><br>5.313 € 6.250€ | <b>18.07. - 25.07.2026</b><br>5.568 € 6.550€ | <b>25.07. - 01.08.2026</b><br>Not available  | <b>01.08. - 08.08.2026</b><br>Not available  |
| <b>08.08. - 15.08.2026</b><br>Not available  | <b>15.08. - 22.08.2026</b><br>4.480 € 6.400€ | <b>22.08. - 29.08.2026</b><br>Not available  | <b>29.08. - 05.09.2026</b><br>Not available  |
| <b>05.09. - 12.09.2026</b><br>On option      | <b>12.09. - 19.09.2026</b><br>On option      | <b>19.09. - 26.09.2026</b><br>Not available  | <b>26.09. - 03.10.2026</b><br>3.088 € 3.250€ |
| <b>03.10. - 10.10.2026</b><br>Not available  | <b>10.10. - 17.10.2026</b><br>1.560 € 2.600€ | <b>17.10. - 24.10.2026</b><br>1.435 € 2.050€ | <b>24.10. - 31.10.2026</b><br>1.430 € 2.200€ |
| <b>31.10. - 07.11.2026</b><br>Not available  | <b>07.11. - 14.11.2026</b><br>1.725 € 2.300€ | <b>15.11. - 31.12.2026</b><br>Not available  |  |

# PRICE AND AVAILABILITY

Lagoon 40 Mars (2020)



|  |  |  |  |
|--|--|--|--|
| <b>01.01. - 05.03.2027</b><br>Not available              | <b>06.03. - 13.03.2027</b><br>2.678 € <del>3.150 €</del> | <b>13.03. - 20.03.2027</b><br>2.678 € <del>3.150 €</del> | <b>20.03. - 27.03.2027</b><br>2.678 € <del>3.150 €</del> |
| <b>27.03. - 03.04.2027</b><br>2.635 € <del>3.100 €</del> | <b>03.04. - 10.04.2027</b><br>2.550 € <del>3.000 €</del> | <b>10.04. - 17.04.2027</b><br>2.635 € <del>3.100 €</del> | <b>17.04. - 24.04.2027</b><br>2.678 € <del>3.150 €</del> |
| <b>24.04. - 01.05.2027</b><br>2.678 € <del>3.150 €</del> | <b>01.05. - 08.05.2027</b><br>2.848 € <del>3.350 €</del> | <b>08.05. - 15.05.2027</b><br>2.933 € <del>3.450 €</del> | <b>15.05. - 22.05.2027</b><br>3.315 € <del>3.900 €</del> |
| <b>22.05. - 29.05.2027</b><br>3.825 € <del>4.500 €</del> | <b>29.05. - 05.06.2027</b><br>4.463 € <del>5.250 €</del> | <b>05.06. - 12.06.2027</b><br>5.228 € <del>6.150 €</del> | <b>12.06. - 19.06.2027</b><br>5.568 € <del>6.550 €</del> |
| <b>19.06. - 26.06.2027</b><br>5.908 € <del>6.950 €</del> | <b>26.06. - 03.07.2027</b><br>6.375 € <del>7.500 €</del> | <b>03.07. - 10.07.2027</b><br>6.630 € <del>7.800 €</del> | <b>10.07. - 17.07.2027</b><br>6.843 € <del>8.050 €</del> |
| <b>17.07. - 24.07.2027</b><br>6.970 € <del>8.200 €</del> | <b>24.07. - 31.07.2027</b><br>7.098 € <del>8.350 €</del> | <b>31.07. - 07.08.2027</b><br>7.225 € <del>8.500 €</del> |  |