

HANSE 460

Freebe (2022)



Allure Navis D.O.O. • Antuna Branka Šimića 33 • 21000 Split • Croatia

Phone: +385 95 502 0094

Phone 2: +385 99 844 2210

E-mail: info@allure-navis.com

Web: www.allure-navis.com

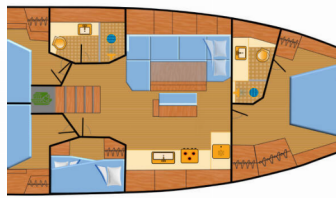

| | |
|------------------------|--|
| Yacht Base | Marina Tehnomont Veruda, Pula, Croatia |
| Yacht ID | 1513 |
| Yacht Brands | Hanse Yachts |
| Yacht Name | Freebe |
| Production Year | 2022 |
| Length | 48 Ft |
| Cabins | 4 |
| Berths | 8 + 2 |
| Max Persons | 10 |
| WC/Shower | 2 |

COMFORT: Cockpit cushions

DECK: Anchor light, Anchor with chain, Bathing platform, Bimini top, Cockpit fridge, Cockpit table, Cockpit/stern, outside shower, Electric anchor windlass, Grill/Barbecue/Plancha, Remote control for anchor winch with chain counter at helm, Removable cockpit bench, Set for steerman (helmsman's chair), Spare anchor (Reserve, Auxiliary anchor), Swimming ladder, Teak cockpit

ENTERTAINMENT: Radio, TV, USB, Wet bar, Wi-Fi Internet

GALLEY: Freezer, Gas cookers, Hot water, Kitchen utensils (Galley equipment, cutlery), Oven, Pressurized water system, Refrigerator, Sink

INTERIOR: Clock, Electric toilet, Hatch shades, Indirect lighting in cabins and salon, LED ceiling lights, LED interior lights, Lowerable salon table, Oak interior, Safe

NAVIGATION: AIS, Autopilot, Binoculars, Bow thruster, Compass, Echosounder/Depthsounder, GPS chart plotter - cockpit, Hand bearing compass, List of lights, Nautical charts, Navigation (Nautical) charts and nautical guide, Navigation/position Lights, Windex

SAFETY: Black Water Tank, Distress signals, Emergency tiller, Fire extinguisher, First aid kit, Flashlight, Fog horn, Life buoy + Flashing light, Lifelines, Liferaft, Self inflating life vest, Set of tools, Torch, VHF radio, Wire (shroud) cutter

SAILS: Bowsprit, Gennaker-device, Halyard winches, Main sheet winches

YACHT ELECTRICS: Battery charger, Bilge pump - Electric, Converter 220V/12V, Heating, Inverter, Plug 220V, 12 V, Shore power cable, Solar panels

PRICE AND AVAILABILITY

Hanse 460 Freebe (2022)



| | | | |
|--|--|--|--|
| 13.06. - 20.06.2026 Not available | 20.06. - 27.06.2026 Not available | 27.06. - 04.07.2026 Not available | 04.07. - 11.07.2026 Not available |
| 11.07. - 18.07.2026 3.445 € 5.300 € | 18.07. - 25.07.2026 3.445 € 5.300 € | 25.07. - 01.08.2026 Not available | 01.08. - 15.08.2026 Not available |
| 15.08. - 22.08.2026 Not available | 22.08. - 29.08.2026 3.445 € 5.300 € | 29.08. - 05.09.2026 3.445 € 5.300 € | 05.09. - 12.09.2026 3.978 € 5.100 € |
| 12.09. - 19.09.2026 Not available | 19.09. - 26.09.2026 3.744 € 4.800 € | 26.09. - 03.10.2026 3.276 € 4.200 € | 03.10. - 10.10.2026 2.340 € 3.000 € |
| 10.10. - 17.10.2026 Not available | 17.10. - 24.10.2026 1.638 € 2.100 € | 24.10. - 31.10.2026 1.638 € 2.100 € | 31.10. - 07.11.2026 1.638 € 2.100 € |
| 07.11. - 14.11.2026 1.638 € 2.100 € | 14.11. - 21.11.2026 2.100 € | 21.11. - 28.11.2026 2.100 € | 28.11. - 05.12.2026 2.100 € |
| 05.12. - 12.12.2026 2.100 € | 12.12. - 19.12.2026 2.100 € | 19.12. - 26.12.2026 2.100 € | 01.01. - 26.03.2027 Not available |