

# LAGOON 46

Mple (2022)

Allure Navis D.O.O. • Antuna Branka Šimića 33 • 21000 Split • Croatia

Phone: +385 95 502 0094

Phone 2: +385 99 844 2210

E-mail: [info@allure-navis.com](mailto:info@allure-navis.com)

Web: [www.allure-navis.com](http://www.allure-navis.com)

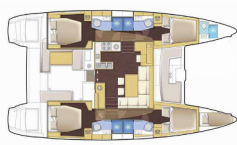

<b>Yacht Base</b>	Athens, Alimos Marina, Greece
<b>Yacht ID</b>	1456
<b>Yacht Brands</b>	Lagoon
<b>Yacht Name</b>	Mple
<b>Production Year</b>	2022
<b>Length</b>	46 Ft
<b>Cabins</b>	4 + 2
<b>Berths</b>	8 + 2
<b>WC/Shower</b>	4 + 1

**COMFORT:** Bed linen, Blankets, Cockpit cushions, Deck cushions, Outside cushions, Towels

**DECK:** Bimini top, Black ball, Boat hook, Cockpit fridge, Deck lights, Dinghy, Dinghy with outboard engine, Electric anchor windlass, Fenders, Hydraulic gangway, Mooring ropes, Spare anchor (Reserve, Auxiliary anchor), Sprayhood, Swimming ladder, Teak cockpit, Winch handles

**ENTERTAINMENT:** Board games, Outdoor speakers, Radio mp3 player, Snorkeling equipment, Stand up paddle (SUP) - FREE, TV, Underwater lights

**GALLEY:** Coffee machine, Electrical filter coffee maker, Electrical kettle, Freezer, NESPRESSO coffee machine, Oven, Refrigerator, Stove, Toaster

**INTERIOR:** Barometer, Electric fans, Electric fans in cabins, Electric toilet

**NAVIGATION:** Autopilot, Compass, Echosounder/Depthsounder, GPS chart plotter, Nautical charts, Pilot book, Speedometer (Speed log), Wind instrument/Anemometer, Windex

**SAFETY:** Black Water Tank, Distress flare box, Emergency tiller, EPIRB-Distress radio beacons, Fire extinguisher, First aid kit, Fog horn, Horseshoe lifebuoy, Life belts (Safety harness), Life jackets, Lifteraft, Sos Dan Buoy, VHF radio

**SAILS:** Electric winch, Lazy bag, Lazy jacks

**YACHT ELECTRICS:** Air Conditioning, Batteries, Battery charger, Generator, Inverter, Shore power connection, USB sockets, Watermaker - desalinator

# PRICE AND AVAILABILITY

Lagoon 46 Mple (2022)



<b>18.04. - 25.04.2026</b> 4.320 € <del>4.800 €</del>	<b>25.04. - 02.05.2026</b> 3.851 € <del>5.100 €</del>	<b>02.05. - 09.05.2026</b> Not available	<b>09.05. - 16.05.2026</b> 4.401 € <del>6.750 €</del>
<b>16.05. - 23.05.2026</b> 4.901 € <del>6.750 €</del>	<b>23.05. - 30.05.2026</b> 5.920 € <del>7.400 €</del>	<b>30.05. - 06.06.2026</b> Not available	<b>06.06. - 13.06.2026</b> Not available
<b>13.06. - 20.06.2026</b> 7.000 € <del>8.600 €</del>	<b>20.06. - 27.06.2026</b> Not available	<b>27.06. - 04.07.2026</b> 8.201 € <del>10.200 €</del>	<b>04.07. - 11.07.2026</b> 8.900 € <del>10.200 €</del>
<b>11.07. - 18.07.2026</b> 8.900 € <del>10.200 €</del>	<b>18.07. - 25.07.2026</b> Not available	<b>25.07. - 01.08.2026</b> 8.901 € <del>11.800 €</del>	<b>01.08. - 08.08.2026</b> 10.178 € <del>11.800 €</del>
<b>08.08. - 15.08.2026</b> Not available	<b>15.08. - 22.08.2026</b> 10.178 € <del>11.800 €</del>	<b>22.08. - 29.08.2026</b> 8.536 € <del>10.400 €</del>	<b>29.08. - 05.09.2026</b> Not available
<b>05.09. - 12.09.2026</b> 9.000 € <del>10.000 €</del>	<b>12.09. - 19.09.2026</b> Not available	<b>19.09. - 03.10.2026</b> Not available	<b>03.10. - 10.10.2026</b> 5.670 € <del>6.300 €</del>
<b>10.10. - 17.10.2026</b> 5.670 € <del>6.300 €</del>	<b>17.10. - 24.10.2026</b> 4.320 € <del>4.800 €</del>	<b>24.10. - 31.10.2026</b> 4.320 € <del>4.800 €</del>	<b>31.10. - 07.11.2026</b> 4.320 € <del>4.800 €</del>
<b>07.11. - 14.11.2026</b> 4.320 € <del>4.800 €</del>	<b>14.11. - 21.11.2026</b> 4.320 € <del>4.800 €</del>	<b>22.11. - 31.12.2026</b> Not available	