

# OCEANIS CLIPPER 411

Erika (2000)



Allure Navis D.O.O. • Antuna Branka Šimića 33 • 21000 Split • Croatia

Phone: +385 95 502 0094

Phone 2: +385 99 844 2210

E-mail: [info@allure-navis.com](mailto:info@allure-navis.com)

Web: [www.allure-navis.com](http://www.allure-navis.com)

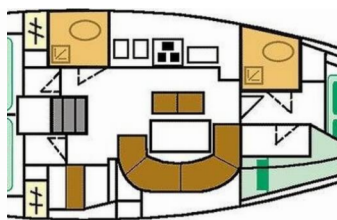

<b>Yacht Base</b>	Volos, Greece
<b>Yacht ID</b>	10522
<b>Yacht Brands</b>	Beneteau
<b>Yacht Name</b>	Erika
<b>Production Year</b>	2000
<b>Length</b>	42 Ft
<b>Cabins</b>	4
<b>Berths</b>	8 + 2
<b>Max Persons</b>	10
<b>WC/Shower</b>	2

**COMFORT:** Cockpit cushions, Salon cushions

**DECK:** Bilge pump - Mechanic, Bimini top, Boat hook, Bosun's chair (Safe seat)(boatswain's chair), Cockpit table, Cockpit/stern, outside shower, Dinghy, Electric anchor windlass, Fenders, Gangway, Mooring ropes, Outboard engine, Spare anchor (Reserve, Auxiliary anchor), Sprayhood, Swimming ladder, Winch handles

**ENTERTAINMENT:** CD player, Indoor speakers, Outdoor speakers, Radio

**GALLEY:** Coffee machine, Freezer, Hot water, Oven, Water pump

**INTERIOR:** Barometer, Electric fans, Electric toilet

**NAVIGATION:** Autopilot, Compass, Echosounder/Depthsounder, GPS, GPS chart plotter, Log/speed instrument, Navigation/position Lights, Radar reflector, Wind instrument/Anemometer

**SAFETY:** Distress flare box, Emergency tiller, EPIRB-Distress radio beacons, Fire extinguisher, First aid kit, Fog horn, Horseshoe lifebuoy, Life belts (Safety harness), Life jacket (children), Life jackets, Liferaft, Set of tools, VHF radio

**SAILS:** Electric winch

**YACHT ELECTRICS:** Battery charger, Bilge pump - Electric, Shore connection 220 V, Shore power cable, Solar panels, Start battery

# PRICE AND AVAILABILITY

Oceanis Clipper 411 Erika (2000)



<b>11.07. - 18.07.2026</b> Not available	<b>20.07. - 24.07.2026</b> Not available	<b>25.07. - 01.08.2026</b> 3.200 €	<b>03.08. - 12.08.2026</b> Not available
<b>15.08. - 22.08.2026</b> 3.200 €	<b>22.08. - 29.08.2026</b> 2.800 €	<b>29.08. - 05.09.2026</b> 2.800 €	<b>05.09. - 12.09.2026</b> 2.800 €
<b>12.09. - 19.09.2026</b> 2.500 €	<b>19.09. - 26.09.2026</b> 2.500 €	<b>30.09. - 10.10.2026</b> Not available	<b>10.10. - 17.10.2026</b> 2.100 €
<b>17.10. - 24.10.2026</b> 2.000 €	<b>24.10. - 31.10.2026</b> 2.000 €	<b>31.10. - 07.11.2026</b> 2.000 €	<b>07.11. - 14.11.2026</b> 2.000 €
<b>14.11. - 21.11.2026</b> 2.000 €	<b>21.11. - 28.11.2026</b> 2.000 €	<b>28.11. - 05.12.2026</b> 2.000 €	<b>05.12. - 12.12.2026</b> 2.000 €
<b>12.12. - 19.12.2026</b> 2.000 €	<b>19.12. - 26.12.2026</b> 2.000 €		